

# IMPORTANT SAFETY AND INSTALLATION INSTRUCTIONS

**WARNING:** Risk of fire and electrical shock. This product is to be installed by a qualified electrician only.

**CAUTION:** When using electrical equipment, basic safety precautions should always be followed including the following: Read all instructions carefully before installation and save

for future use. Make sure installation and all connections are in accordance with National Electrical Code and any local regulations. To avoid possible electrical shock, be sure that power supply is turned off before installing or servicing this fixture. Servicing should be performed by qualified service personnel.

These instructions do not claim to cover all details or variations. When additional information is desired, please contact your SPI representative.

## LIGHTRUSS LED UPGRADE - 1000W MODULE

STEP 1: Remove Covers, Ballast, Glass, and Lamp.

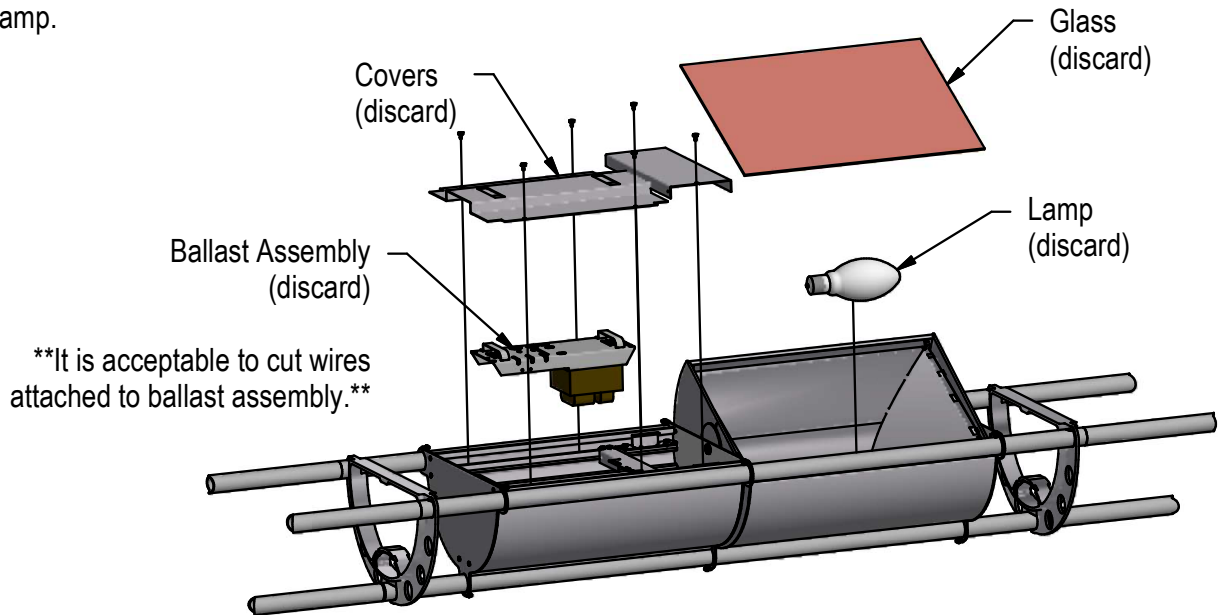

STEP 2: Cut Wires.

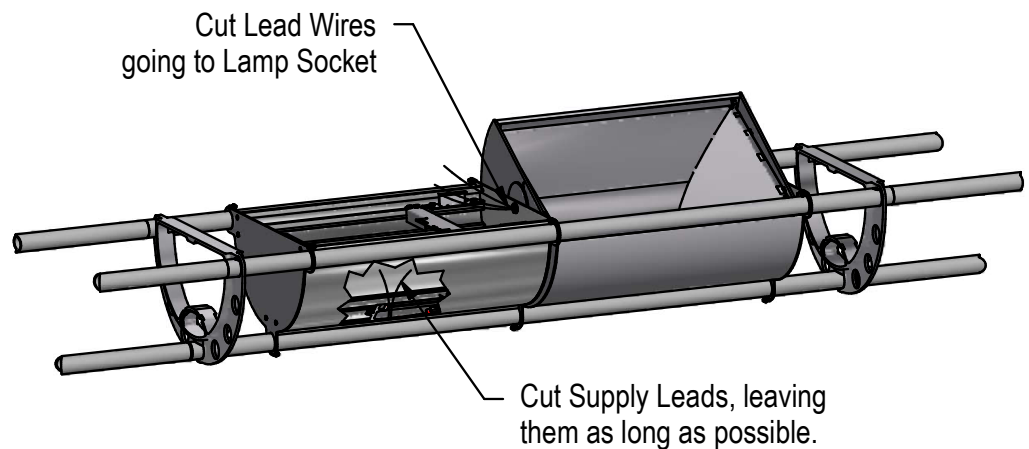

\*\*Supply Leads may originate from any of the three tubes.\*\*

Page 1

09/21/21  
IS111502X

# IMPORTANT SAFETY AND INSTALLATION INSTRUCTIONS

**WARNING:** Risk of fire and electrical shock. This product is to be installed by a qualified electrician only.

**CAUTION:** When using electrical equipment, basic safety precautions should always be followed including the following: Read all instructions carefully before installation and save

for future use. Make sure installation and all connections are in accordance with National Electrical Code and any local regulations. To avoid possible electrical shock, be sure that power supply is turned off before installing or servicing this fixture. Servicing should be performed by qualified service personnel.

These instructions do not claim to cover all details or variations. When additional information is desired, please contact your SPI representative.

## LIGHTRUSS LED UPGRADE - 1000W MODULE

STEP 3: Loosen Set Screws. Remove Nuts and Lock Washers.

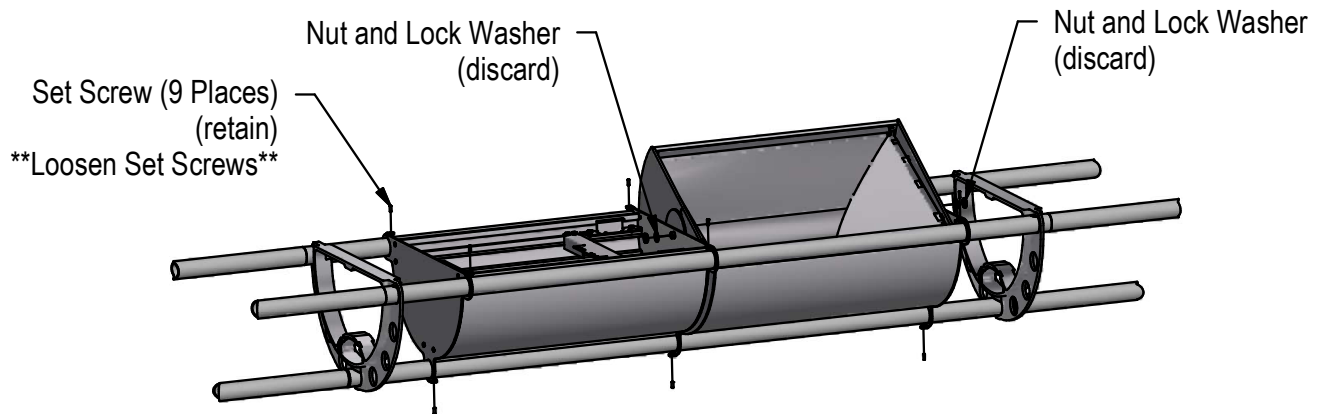

STEP 4: Remove Fixture Housing.

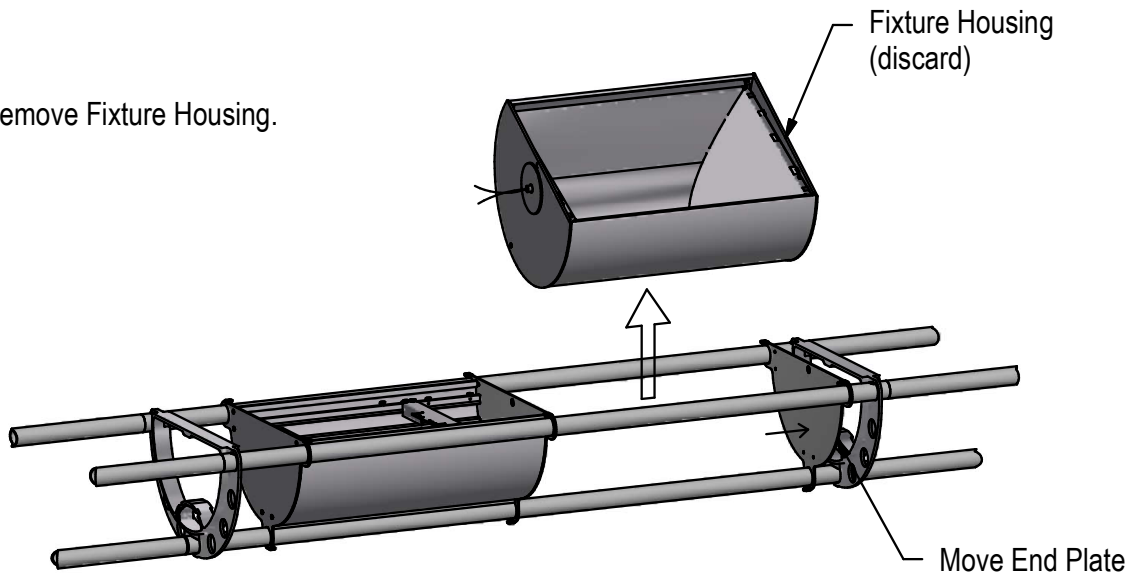

# IMPORTANT SAFETY AND INSTALLATION INSTRUCTIONS

**WARNING:** Risk of fire and electrical shock. This product is to be installed by a qualified electrician only.

**CAUTION:** When using electrical equipment, basic safety precautions should always be followed including the following: Read all instructions carefully before installation and save

for future use. Make sure installation and all connections are in accordance with National Electrical Code and any local regulations. To avoid possible electrical shock, be sure that power supply is turned off before installing or servicing this fixture. Servicing should be performed by qualified service personnel.

These instructions do not claim to cover all details or variations. When additional information is desired, please contact your SPI representative.

## LIGHTRUSS LED UPGRADE - 1000W MODULE

**STEP 5 (OPTION A):** Remove Housing End Plates from Ballast Housing. Remove Ballast Housing.

**\*\*TIP:** Impact driver will help loosen the flat head screws\*\*

**\*\*TIP:** Hammer may be needed to break end plates from housing.\*\*

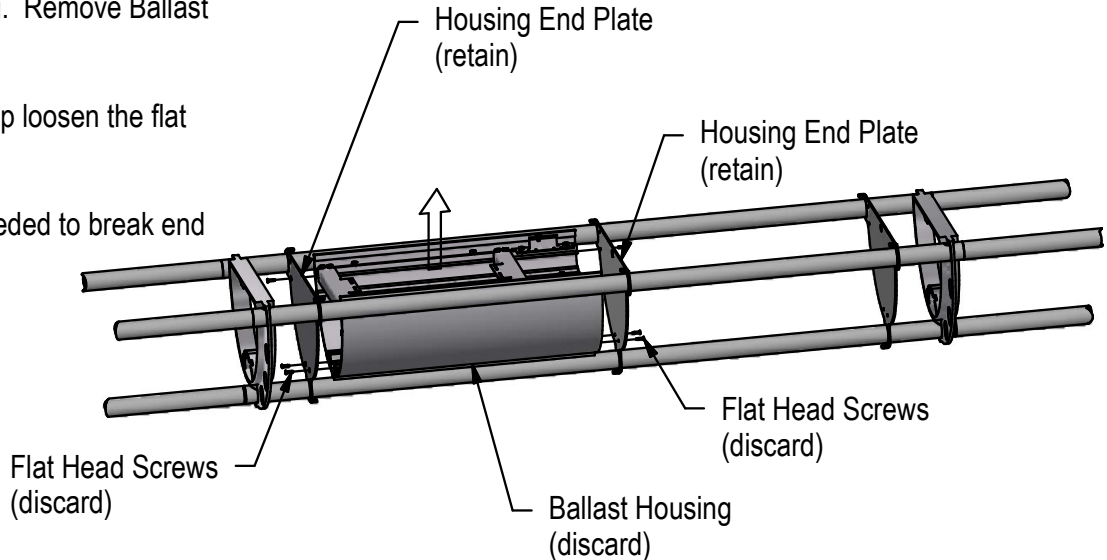

Choose between  
OPTION A or OPTION B

**OPTION A: RETAIN END PLATES (NO CUTTING)**

**OPTION B: CUT OUT OLD HOUSING AND END PLATE**

**STEP 5 (OPTION B):** Cut out Ballast Housing and End Plate.

**\*\*TIP:** Protect truss tube from being damaged during cutting.\*\*

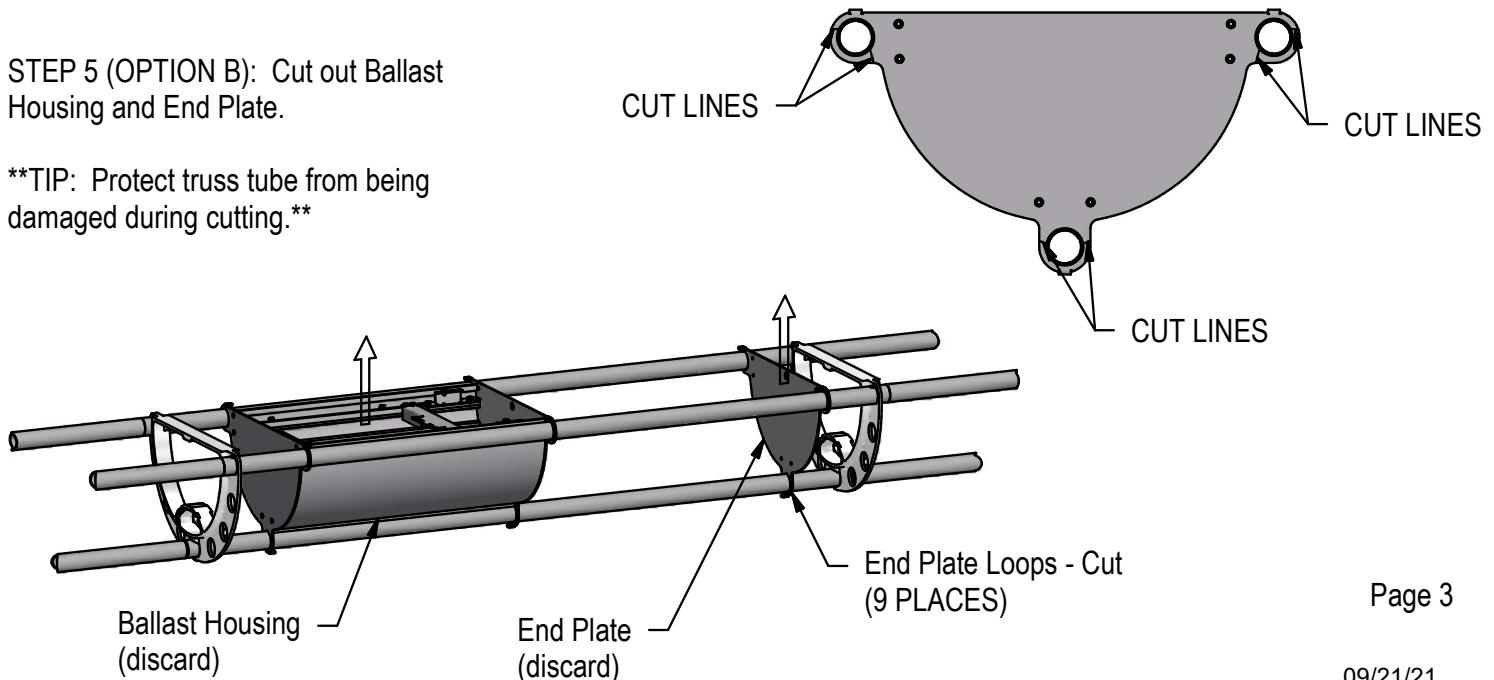

Page 3

09/21/21  
IS111502X

# IMPORTANT SAFETY AND INSTALLATION INSTRUCTIONS

**WARNING:** Risk of fire and electrical shock. This product is to be installed by a qualified electrician only.

**CAUTION:** When using electrical equipment, basic safety precautions should always be followed including the following: Read all instructions carefully before installation and save

for future use. Make sure installation and all connections are in accordance with National Electrical Code and any local regulations. To avoid possible electrical shock, be sure that power supply is turned off before installing or servicing this fixture. Servicing should be performed by qualified service personnel.

These instructions do not claim to cover all details or variations. When additional information is desired, please contact your SPI representative.

## LIGHTRUSS LED UPGRADE - 1000W MODULE

**STEP 6 (OPTION A AND B):** Unpack LED Fixture. Remove Splice Cover for the tube with the Supply Lead Wires. For OPTION A, remove remaining Upper Splice Covers.

**\*\*TIP:** Retain Covers and Screws for completion of installation.\*\*

**\*\*TIP:** Review orientation of light fixture to determine what sides are the Top Inside Tube and the Top Outside Tube.\*\*

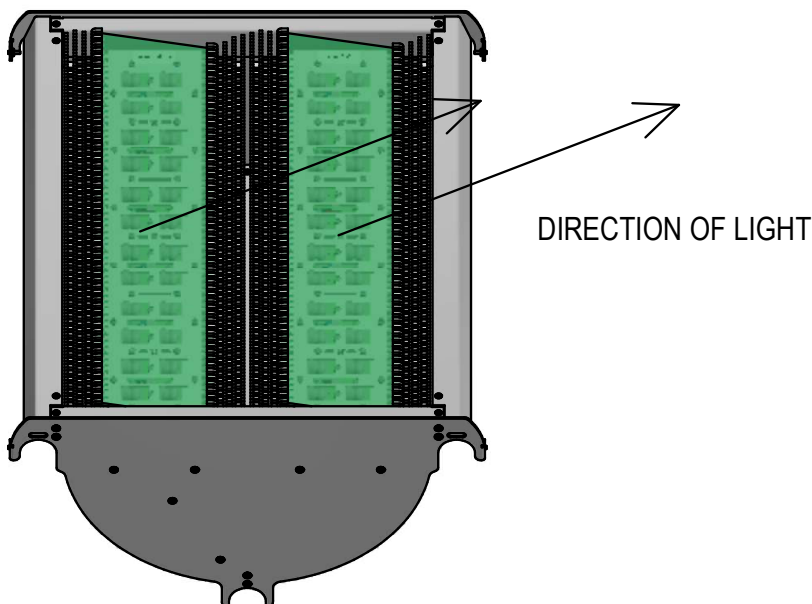
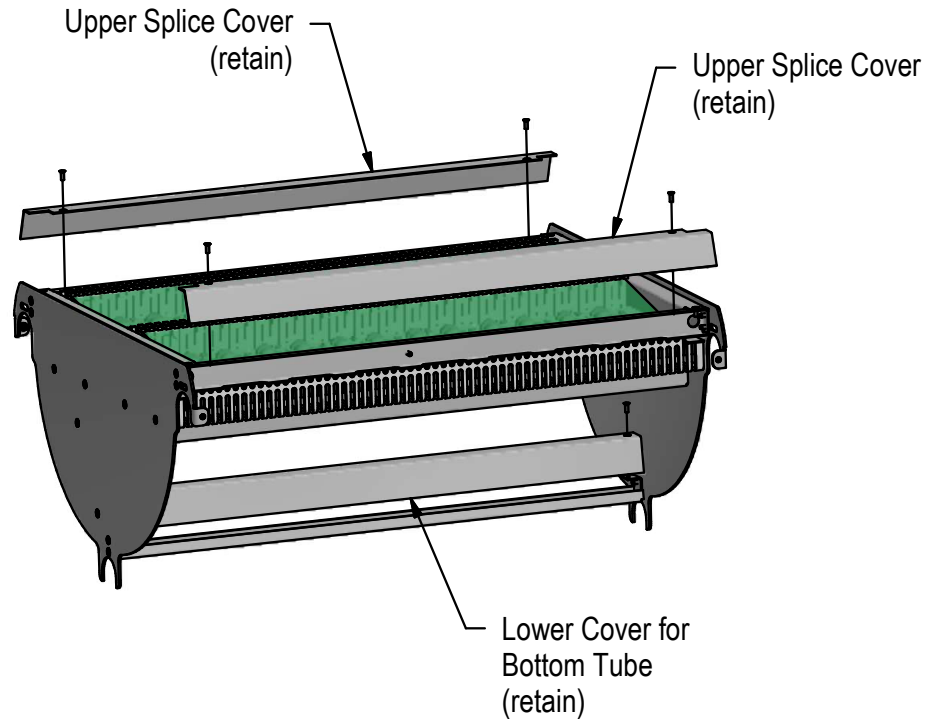

# IMPORTANT SAFETY AND INSTALLATION INSTRUCTIONS

**WARNING:** Risk of fire and electrical shock. This product is to be installed by a qualified electrician only.

**CAUTION:** When using electrical equipment, basic safety precautions should always be followed including the following: Read all instructions carefully before installation and save

for future use. Make sure installation and all connections are in accordance with National Electrical Code and any local regulations. To avoid possible electrical shock, be sure that power supply is turned off before installing or servicing this fixture. Servicing should be performed by qualified service personnel.

These instructions do not claim to cover all details or variations. When additional information is desired, please contact your SPI representative.

## LIGHTRUSS LED UPGRADE - 1000W MODULE

**STEP 7 (OPTION A):** Rest new LED Fixture onto truss in desired location.

**\*\*TIP:** Make sure orientation of fixture light output is facing the correct direction.\*\*

**\*\*TIP:** Fixture location may be adjusted along truss as long as supply lead wires exit truss within fixture.\*\*

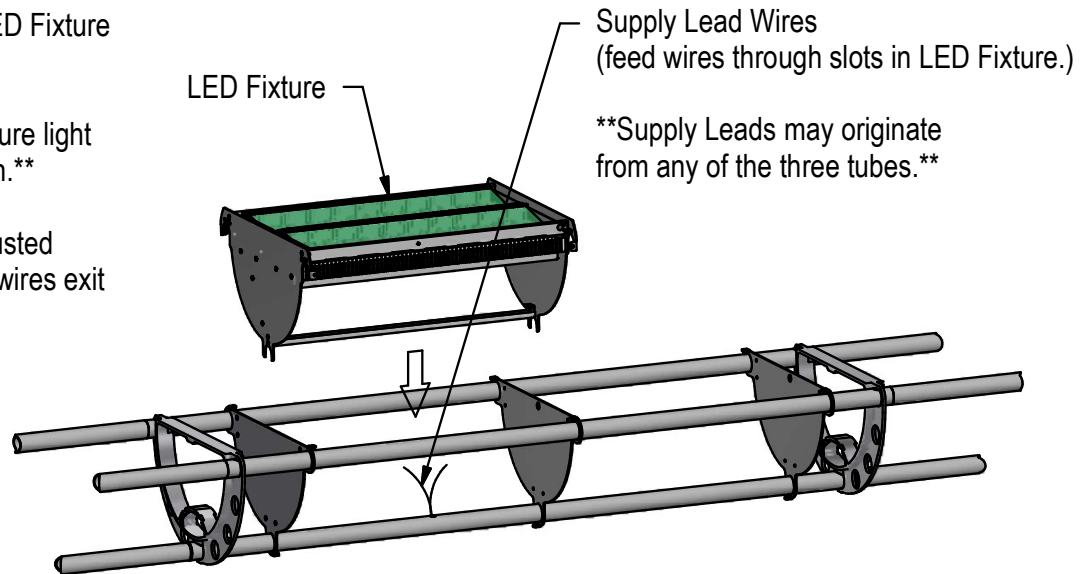

**OPTION A: RETAIN END PLATES (NO CUTTING)**

**OPTION B: CUT OUT OLD HOUSING AND END PLATE**

**STEP 7 (OPTION B):** Rest new LED Fixture onto truss in desired location.

**\*\*TIP:** Make sure orientation of fixture light output is facing the correct direction.\*\*

**\*\*TIP:** Fixture location may be adjusted along truss as long as supply lead wires exit truss within fixture.\*\*

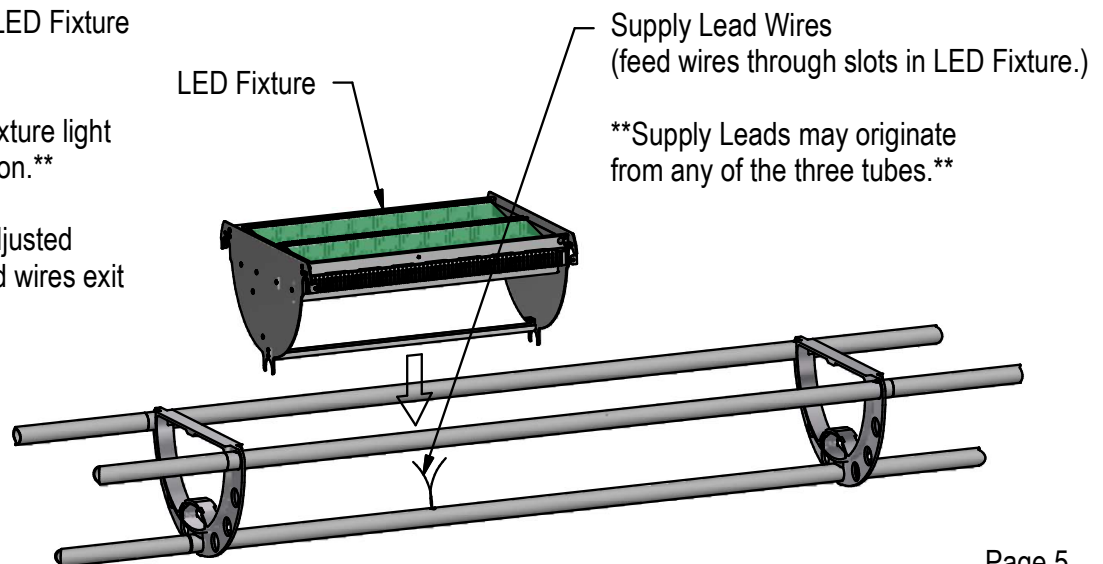

# IMPORTANT SAFETY AND INSTALLATION INSTRUCTIONS

**WARNING:** Risk of fire and electrical shock. This product is to be installed by a qualified electrician only.

**CAUTION:** When using electrical equipment, basic safety precautions should always be followed including the following: Read all instructions carefully before installation and save

for future use. Make sure installation and all connections are in accordance with National Electrical Code and any local regulations. To avoid possible electrical shock, be sure that power supply is turned off before installing or servicing this fixture. Servicing should be performed by qualified service personnel.

These instructions do not claim to cover all details or variations. When additional information is desired, please contact your SPI representative.

## LIGHTRUSS LED UPGRADE - 1000W MODULE

**STEP 8 (OPTION A):** Lock LED Fixture to truss by tightening Side Set Screws. Slide old End Plates over to LED Fixture and secure with set screws.

**\*\*TIP:** Side Set Screws are used to ground the fixture. Tighten to break through paint on tube.\*\*

**\*\*TIP:** Remove top set screws to position end plates flat against LED Fixture. Reinstall set screws.\*\*

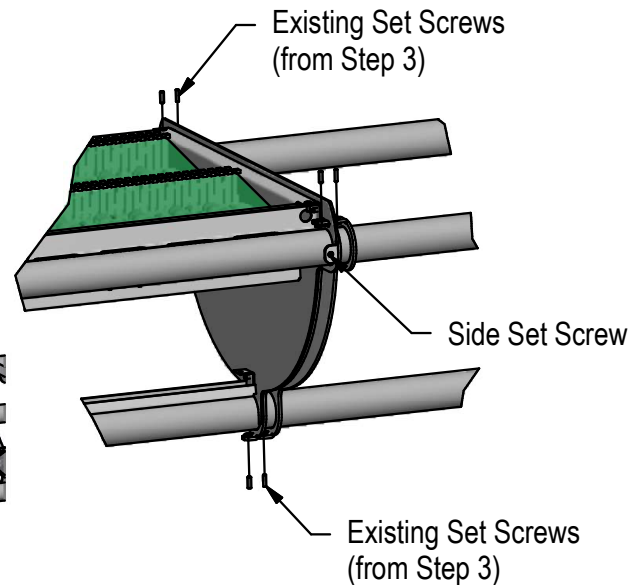
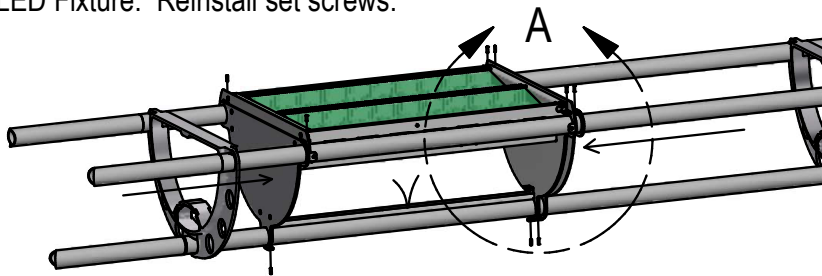

OPTION A: RETAIN END PLATES (NO CUTTING)

OPTION B: CUT OUT OLD HOUSING AND END PLATE

**STEP 8 (OPTION B):** Lock LED Fixture to truss by tightening Side Set Screws.

**\*\*TIP:** Side Set Screws are used to ground the fixture. Tighten to break through paint on tube.\*\*

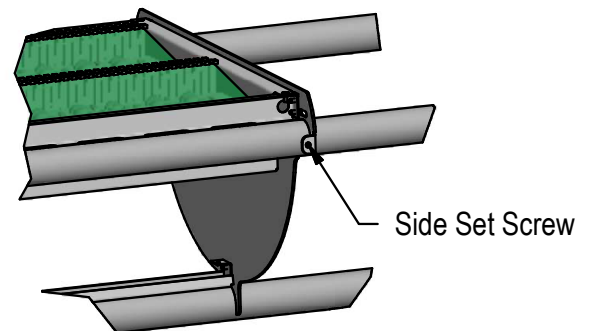
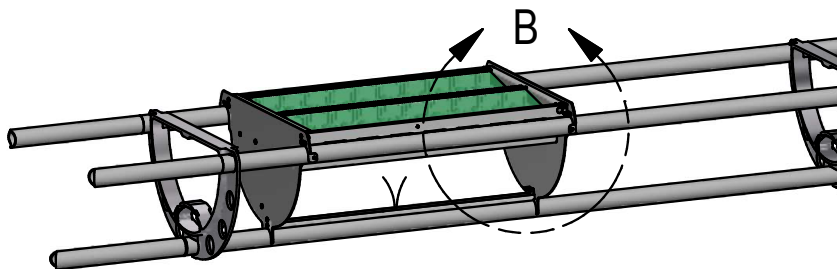



# IMPORTANT SAFETY AND INSTALLATION INSTRUCTIONS

**WARNING:** Risk of fire and electrical shock. This product is to be installed by a qualified electrician only.

**CAUTION:** When using electrical equipment, basic safety precautions should always be followed including the following: Read all instructions carefully before installation and save

for future use. Make sure installation and all connections are in accordance with National Electrical Code and any local regulations. To avoid possible electrical shock, be sure that power supply is turned off before installing or servicing this fixture. Servicing should be performed by qualified service personnel.

These instructions do not claim to cover all details or variations. When additional information is desired, please contact your SPI representative.

## LIGHTRUSS LED UPGRADE - 1000W MODULE

STEP 9 (OPTION A and B): Wire LED Fixture to Supply Leads.

**\*\*TIP:** Supply Leads may originate from any of the three tubes.\*\*

LIGHTRUSS WIRE COLORS  
Typical System, May Vary

( 120V-277V )  
BLACK / WHITE  
BLUE / GRAY  
RED (EM)

( 480V )  
ORANGE / BROWN  
BLACK / RED

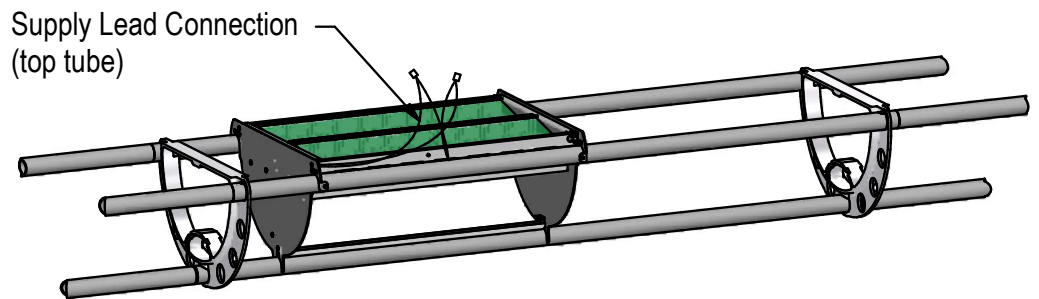
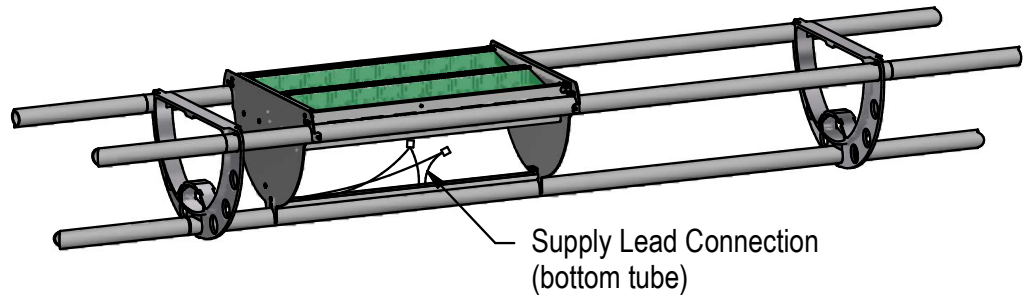

STEP 10 (OPTION A and B): Replace Splice Covers.

